

# POWER-VAC SWEEPERS

**PICKS UP EVERYTHING  
SAVE TIME AND MONEY**



**CLEANS UP TO 40,000 SQUARE FEET/HOUR**  
MACHINE SHOP SHAVINGS, FLAT STOCK, CANS, BOTTLES, BROKEN  
GLASS, SAND, PIECES OF WIRE, STRING, ROPE, ACORNS, WET AND  
DRY LEAVES, PAPER, MILK CARTONS, WRAPPINGS, CUPS, SCREWS,  
WASHERS, PLASTIC BOTTLES, FOAM PACKAGING, NEWSPAPERS,  
SAWDUST & WOOD SHAVINGS, INSULATION, BOXES, ETC.

**ELGEE**  
**POWER-VAC**<sup>TM</sup>

## ELGEE POWER -VAC SWEEPERS

**HANDLE ASSEMBLY:** Install 5 hole handle leg on right side of body with 5/16 - 18 x 1 3/4 bolts, flat washer and elastic stop nuts. Install 3 hole handle leg on left side of body with 5/16 x 1 3/4 flat washers and elastic stop nuts. Reference handle assembly drawing)  
Slide I.D. of each end of the U-handle over expanded end of above legs. NOTE: 2 small holes for mounting of throttle lever will be on the right at the operator position. Install 5/16 - 18 x 1 1/4 bolts through U-handle and legs, then tighten.

**THROTTLE CONTROL:** Install on engine first. See engine instruction sheet. Attach control lever at top of handle with screw provided (see assembly drawing). Use clips to hold control wire casing against handle. Work control for ease of operation and see that speed control on engine moves to both limits. Tighten inner control wire clamp, cut off excess and bend under.

**DEFLECTOR BAFFLE:** Install Deflector Baffle on the discharge chute of sweeper housing. Slide from left to right with ends of deflector baffle in the top and bottom channel of discharge chute. **Do not run the machine without the deflector baffle installed.** (See separate sheet)

**DOLLY ASSEMBLY:** Snaps (light press) over axle for easy attachment and use.

**BAG:** The Elgee bags are designed for use with the dolly platform that keeps the machine in proper balance and the bag from dragging on the ground while in use. When possible open the side vent zipper to allow dust and air to escape. This venting of air will allow the unit to pick up better and longer. When not practical to exhaust dust, close the zipper. **Shake out bag dust often to maintain good suction.**

**BAG INSTALLATION:** Slip the neck of the filter bag over the deflector baffle and past the U channels of the housing. Strap clamp should be just beyond top channel. Allow bag to dry when wet to avoid rotting. Launder only if necessary in cold water with bag inside out. **Do not hot air dry.** Hang to dry.

**ENGINE:** Read engine manual before starting.

**USE OF SWEEPER:** Throttle speed setting and speed of work depends upon debris to be cleaned and frequency of cleaning. Engine speed should be set at lowest RPM and still pick up debris. When encountering large debris such as cans, milk cartons, cups etc push down on handle raising the front of the unit, this will allow debris to pass under and into the unit.

**MAINTENANCE:** Clean bag often. Shake out dust to allow pores to breathe. Check engine oil level with each use. Add oil as needed.

**CHANGE OIL:** Remove filler cap, tilt unit and drain oil into large can. **Always remove spark plug wire from spark plug when working on the engine.** Refill oil as recommended in engine manual. Do not overfill.

### **Limited Warranty**

Elgee equipment carries a one year warranty against mechanical defect and workmanship, except for bags, throttle wires and rubber parts. Should defects develop, parts must be returned to our factory, prepaid, for inspection. Defective parts will be repaired or replaced (customer to furnish labor for removal and replacement of said parts). We will not be responsible for repairs outside of our factory without authorization.

**ENGINE WARRANTY:** Is subject to terms and conditions of the engine manufacturer. Engines may be sent to Elgee Mfg. Co., Inc. or any local motor dealer for repair.

## ELGEE LIMITED WARRANTY

For *ONE YEAR* from date of installation, Elgee will repair or replace (at Elgee's Opinion) for the original purchases, *FREE OF CHARGE*, any parts or parts found upon examination by the factory in Warren, New Jersey, or by any factory authorized center, to be defective in material and or workmanship.

Elgee equipment carries a one-year warranty against mechanical defects and workmanship, except for bags, wiring, fuel tubes, cables, brass nipples, and rubber parts. Should defects develop, parts must be returned to our factory prepaid for inspection. Elgee will not be responsible for repairs made outside of the factory without authorization.

Removal, reconnection, and all transportation charges on parts submitted for replacement under this warranty must be borne by the purchaser.

Any changes or modification of this unit without the expressed written consent of Elgee Manufacturing Company, Inc., will void this warranty.

Anything related to the conversion of an engine to propane fuel burning voids the manufacturers warranty pertaining to any part directly associated with propane fuel combustion. All other engine components carry full manufacturer's warranty.

Engine warranty is carried by the manufacturer and their authorized dealers. Honda engines carry a *TWO-YEAR* warranty. A *ONE-YEAR* warranty is carried on Industrial/Commercial (I/C) engines and 6HP (B&S) Intek engines. A 90-day warranty is offered on the 8HP (B&S) standard engines.

There is no warranty expressed or implied. Elgee and any or all sub-contractors shall in any event **(Not)** be liable for consequential damages.

Implied warranties, including those of merchantability and fitness for a particular purpose are limited to *ONE YEAR* from purchase and to the extent permitted by law and any and all implied warranties are excluded this is the exclusive remedy and liability for consequential damages under any and all warranties. Warranties are excluded to the extent exclusion permitted by law.

E-mail: [sales@elgee.com](mailto:sales@elgee.com)

Website: [www.elgee.com](http://www.elgee.com)

POWER VAC SWEEPER GASOLINE WITH HOSE 30'-40'

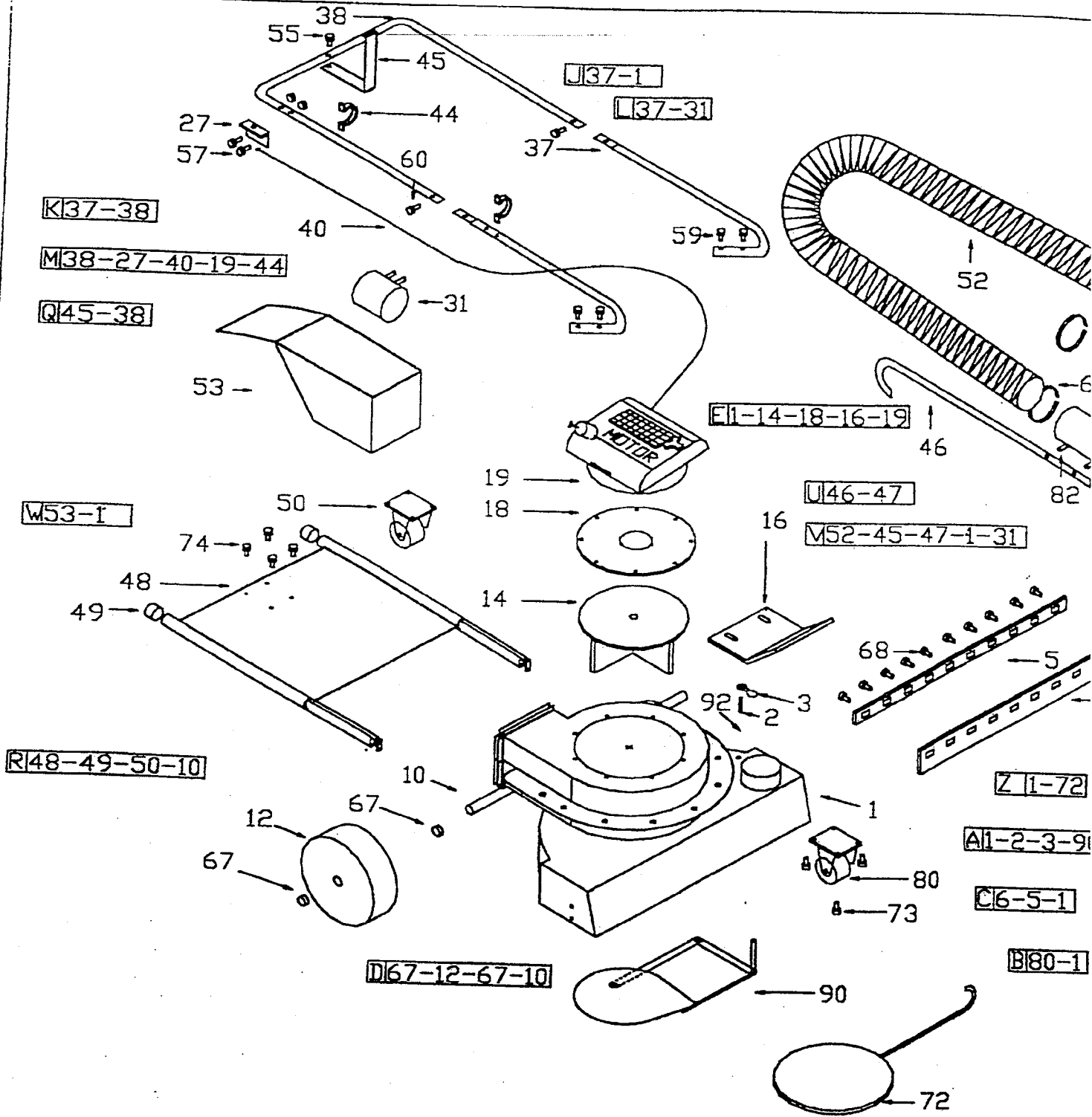

POWER-VAC-SWEEPER-GASOLINE 30-40" -PARTS LIST

With Hose and Auto Baffle # 90 or Hose Baffle # 72

DETAIL	PC.No.	NAME	DESCRIPTION	ELGEE symbol 30"
A	1	Invoice		
	90	Auto Baffle Plate		
	2	Spring		
B	3	Handle		
	30	Front Swivel Wheel		FW - 30
C	1	Invoice		
	5	Rear Flap Metal Clamp		IV - 03 IV - 43
	6	Rear Rubber Flap		IV - 02 IV - 42
D	1	Invoice		
	67	Spacer	left and right	
	12	Side wheel Martin 1" Dia	2 pcs	SW - 16
	67	Shaft Collar 3/4" Dia	4 pcs	SW - 30
E	10	Axle		SW - 18
	1	Invoice		
	14	Impeller		
	18	Motor Mount Plate		
	16	Air Shield	HONDA only	
J	19	Motor	HONDA / E&S	
	37	Leg	2 pcs	HA - 16
K	1	Invoice		
	37	Leg		HA - 16
L	38	"J" Handle		HA - 18
	37	Leg		HA - 16
M	31	Hose Cup		HO - 44
	38	"J" Handle		HA - 13
	27	Drive Control Arm		
	40	Remote Control Cable		
	19	Motor	Honda / E&S	
Q	44	Clamps	2 pcs	
	45	Hose Retainer Bracket		HO - 47
R	38	"J" Handle		HA - 47
	48	Dolly Platform		DA - 00
	49	Dolly Rubber Tire		DA - 02
	50	Dolly Swivel Wheel		DA - 03
U	10	Axle		SW - 25
	46	Hose Case		HO - 13
V	47	Hose Tube		HO - 38
	52	Hose		HO - 30
	45	Hose Retainer Bracket		HO - 47
	47	Hose Tube		HO - 38
	66	Clamps	2 pcs	
	31	Hose Cup		HO - 44
W	53	Deflector Baffle		DB - 00
	1	Invoice		
Z	1	Invoice		
	72	Hose Baffle Plate		HO - 60
STANDARD PARTS				
	55	Screw , washes, Nut	5/16-18 x 1 1/4	
	59	Screw , washes, Nut	5/16-18 x 1 1/4	
	73	Screw , washes, Nut	5/16-18 x 1 1/4	
	74	Screw , washes, Nut	5/16-16 x 1	
	68	Screw , washes, Nut	5/16-18 x 1 1/2	
	57	Screw , washes, Nut	10-24 x 1 1/4	

POWER VAC SWEEPER GASOLINE WITH HOSE 30"-40"

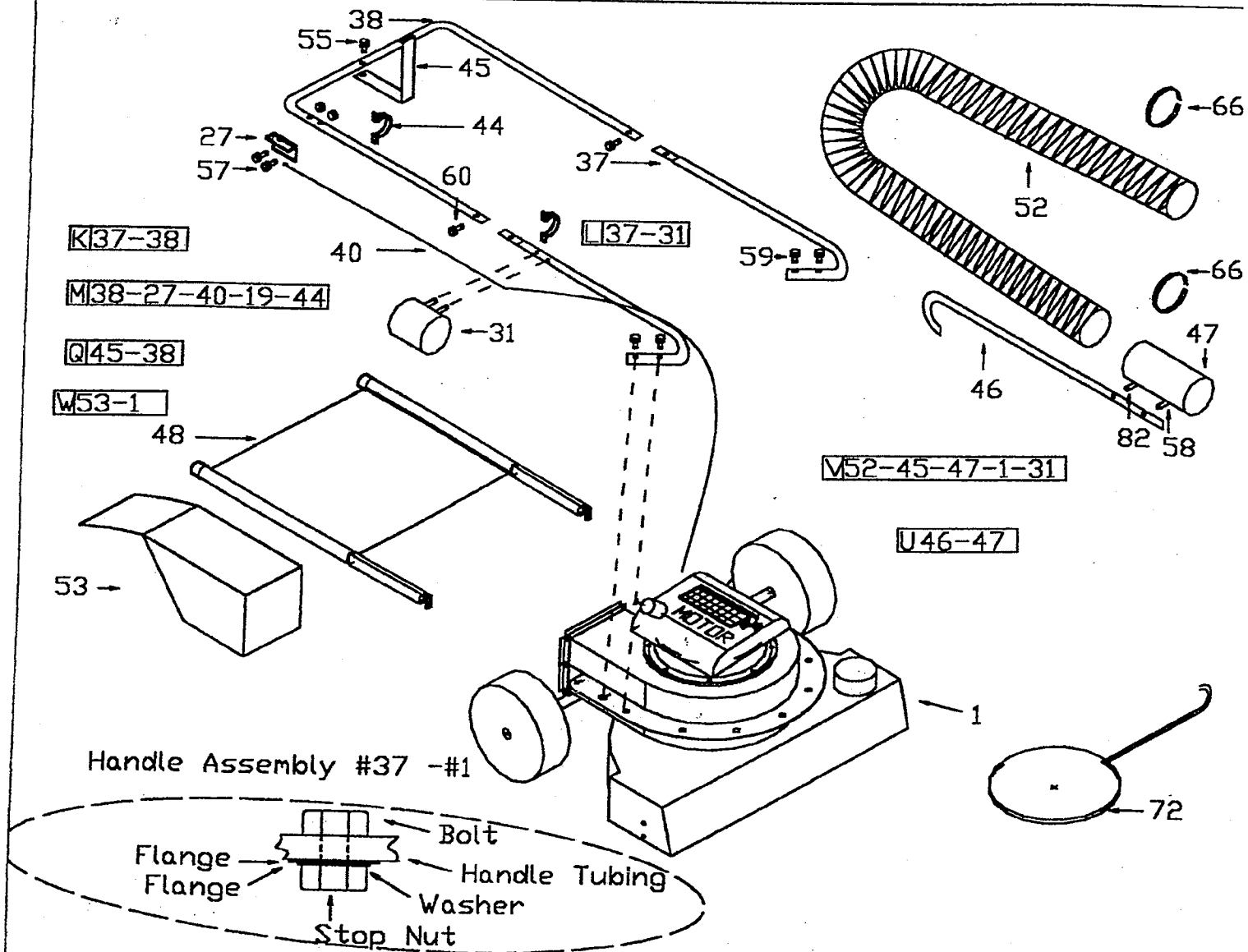

DETAIL	PC NR	NAME	DESCRIPTION
	45	Hose Retainer Bracket	
	38	"U" Handle	
	55	Screw 5/16-18 x 1 1/4	
	37	Leg	2 pcs
	31	Hose Cup	
	48	Dolly Platform	
	53	Deflector Baffle	
	52	Hose	
	46	Cane	
	47	Hose Tube	
	59	Screw and Nut 5/16-18x1 3/4	4 pcs
	60	Screw and Nut 5/16-18x1 1/4	2 pcs
	72	Hose Baffle Plate	
	27	Throttle Control	
	44	Clamp	2 pcs
	57	Screws and Nuts 10-24	2 pcs

## DEFLECTOR BAFFLE

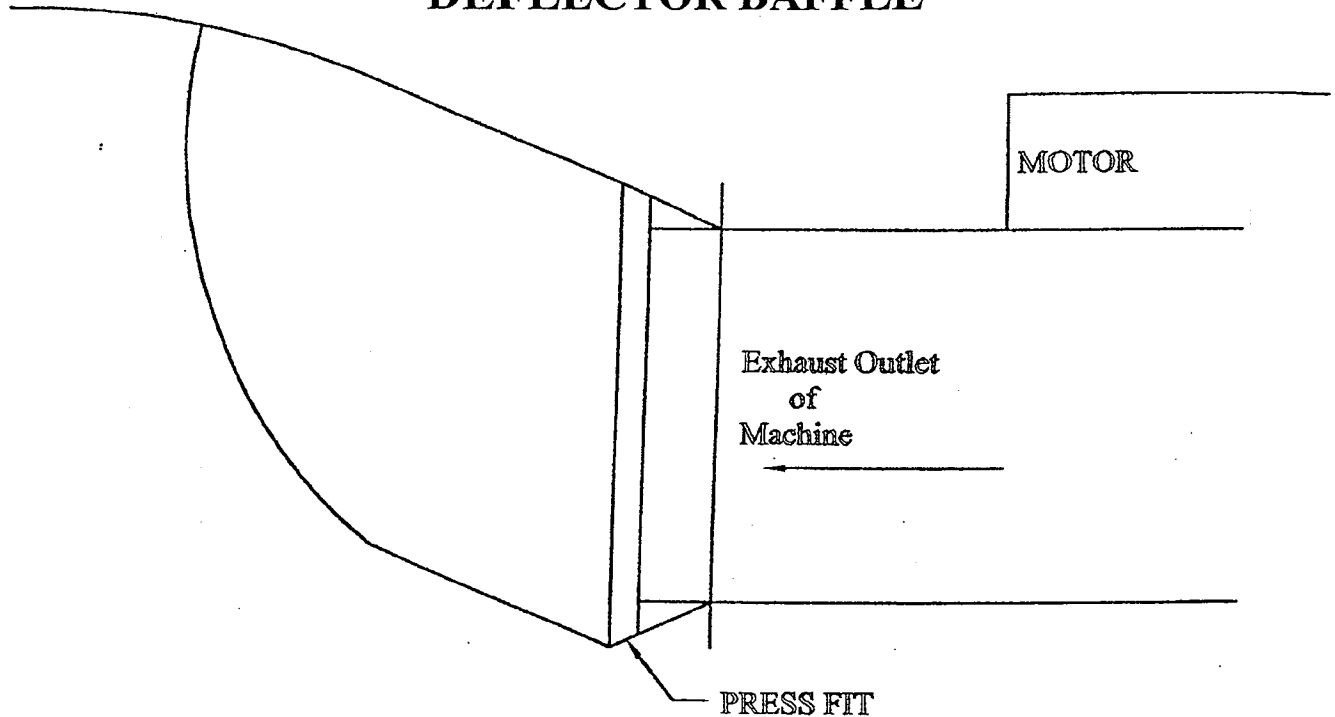

### APPLICATION:

- (a) Used to provide additional protection for bags when recovering heavy or sharp debris.
- (b) Especially necessary when using booster baffle.
- (c) Very helpful in providing dead air space when recovering excess dust. Prolongs emptying cycle of bag during heavy dust conditions (merely shut off machine and shake bag down)

### INSTALLATION:

- (a) Install by sliding the Deflector sideways in top and bottom exhaust channels as shown above. Press fit is required. Start at the Center of the machine and strike with mallet or wood to slide until centered over exhaust outlet.
- (b) If Deflector does not fit tightly in channels, remove and bend bottom edge of 16 gauge sheet metal lip up slightly, for Press fit.
- (c) With Deflector in place the bag may then be attached. The bag fits over both channels, then tighten bags Draw String.
- (d) Care should be taken not to push the handle down toward floor further than necessary as it will force the Deflector against the dolly and it will peel off.

**DO NOT RUN THE MACHINE WITHOUT DEFLECTOR BAFFLE INSTALLED!**